

ONE Greenville

weave (vb.) interlacing two things to make something new

Rooted in research, this mixed-use urban infill project finds inspiration and innovation in the rich textile history and high tech textile future of this southern city. A dense mixed use program of ground level retail, office, university with green roof, corporate bank headquarters and training facility, and a parking structure are all woven into an already spirited main street.

The heart of the project is an urban plaza which stitches the project into the vitality of main street and provides a flexible space for markets, performances, festivals, people watching and everyday pause. The pattern, scale, detail, texture, luminosity, dynamism and beauty of finely crafted textiles are also attributes of this vibrant urban space; this plaza and surrounding development promise to strengthen the economic and civic health of this great city.

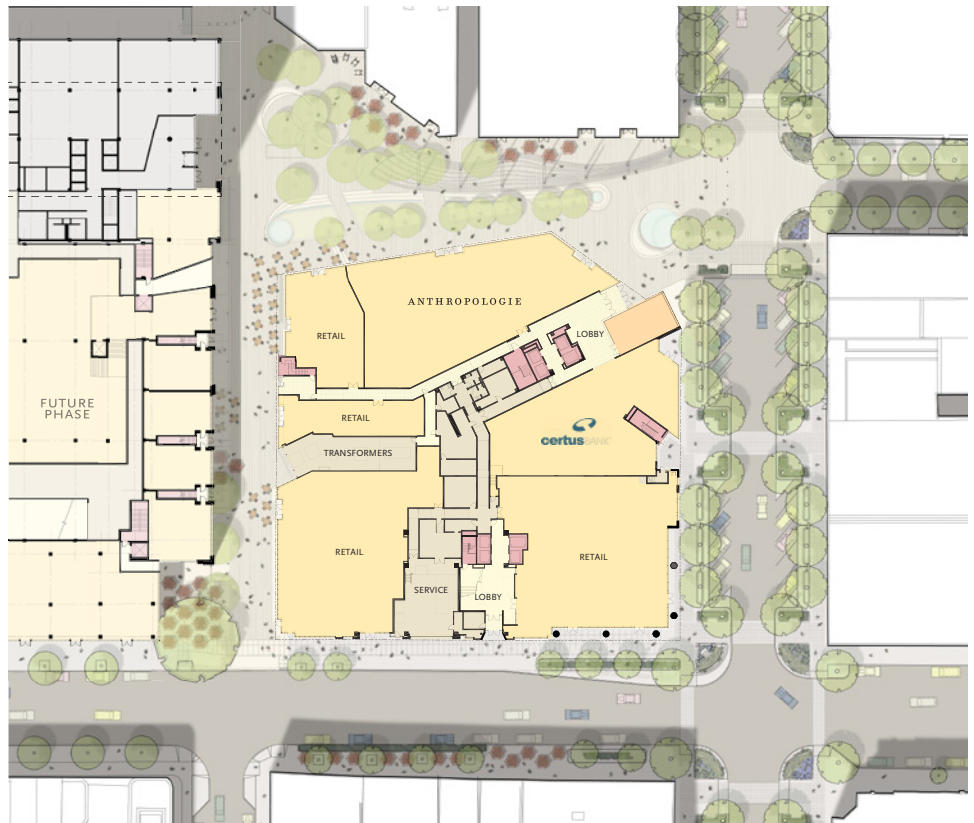

ONE Greenville

location: Greenville, SC
total square feet:
0.5 Acre Piazza
40,000 - 50,000 sq. ft. Retail
235,000 sq. ft. Office
targeting LEED Gold

